

現況圖

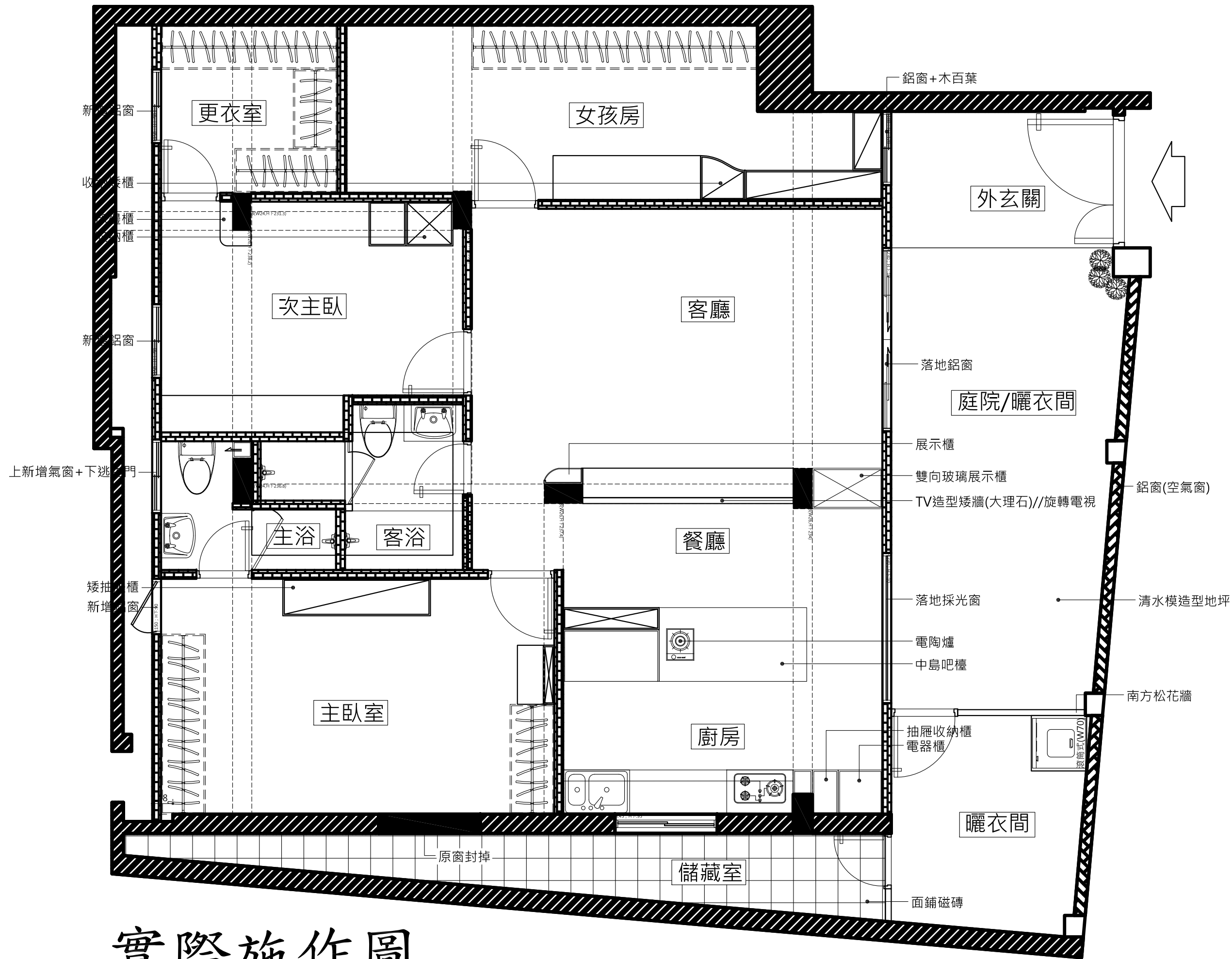

實際施作圖

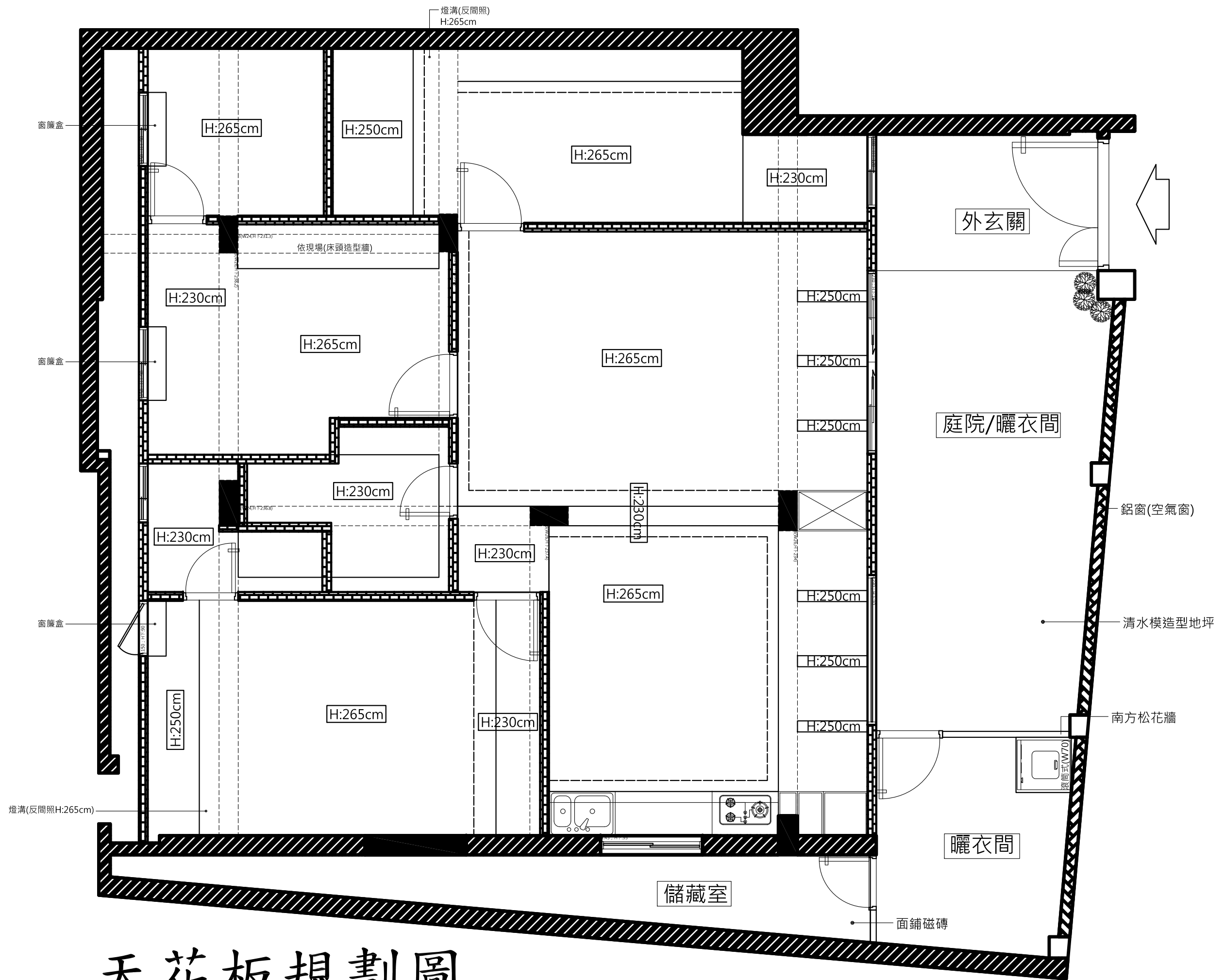

天花板規劃圖

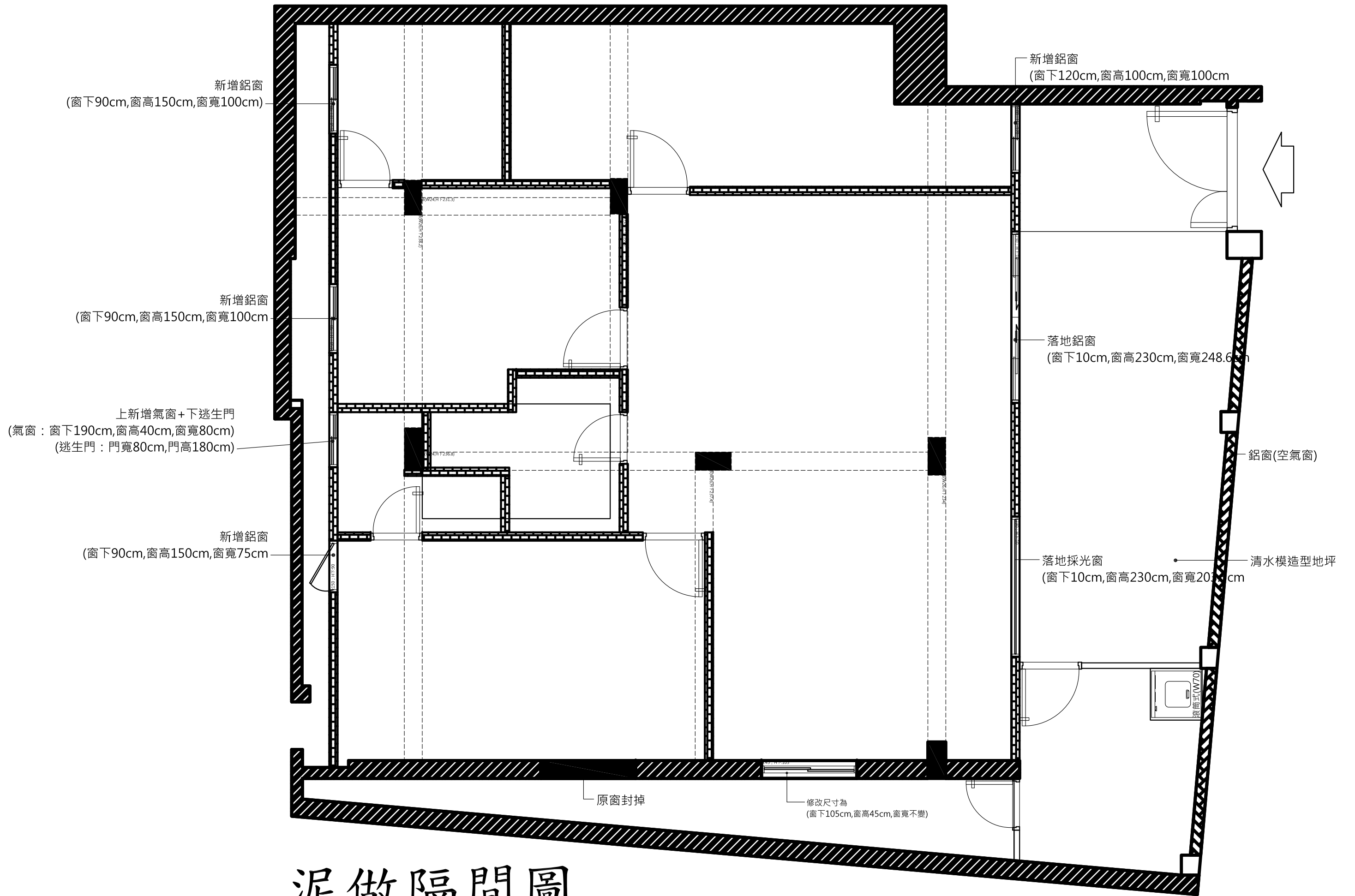

泥做隔間圖

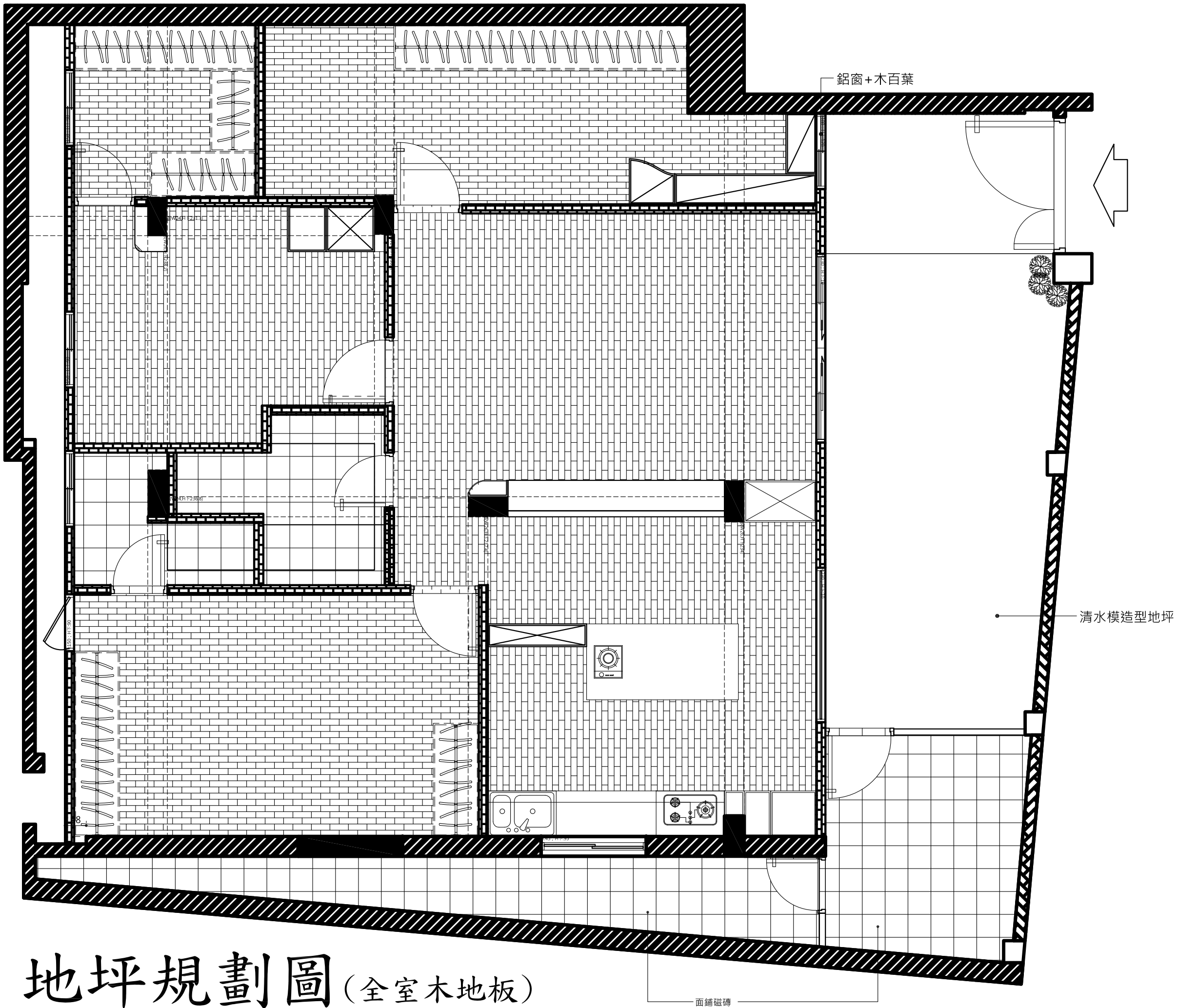

地坪規劃圖 (全室木地板)

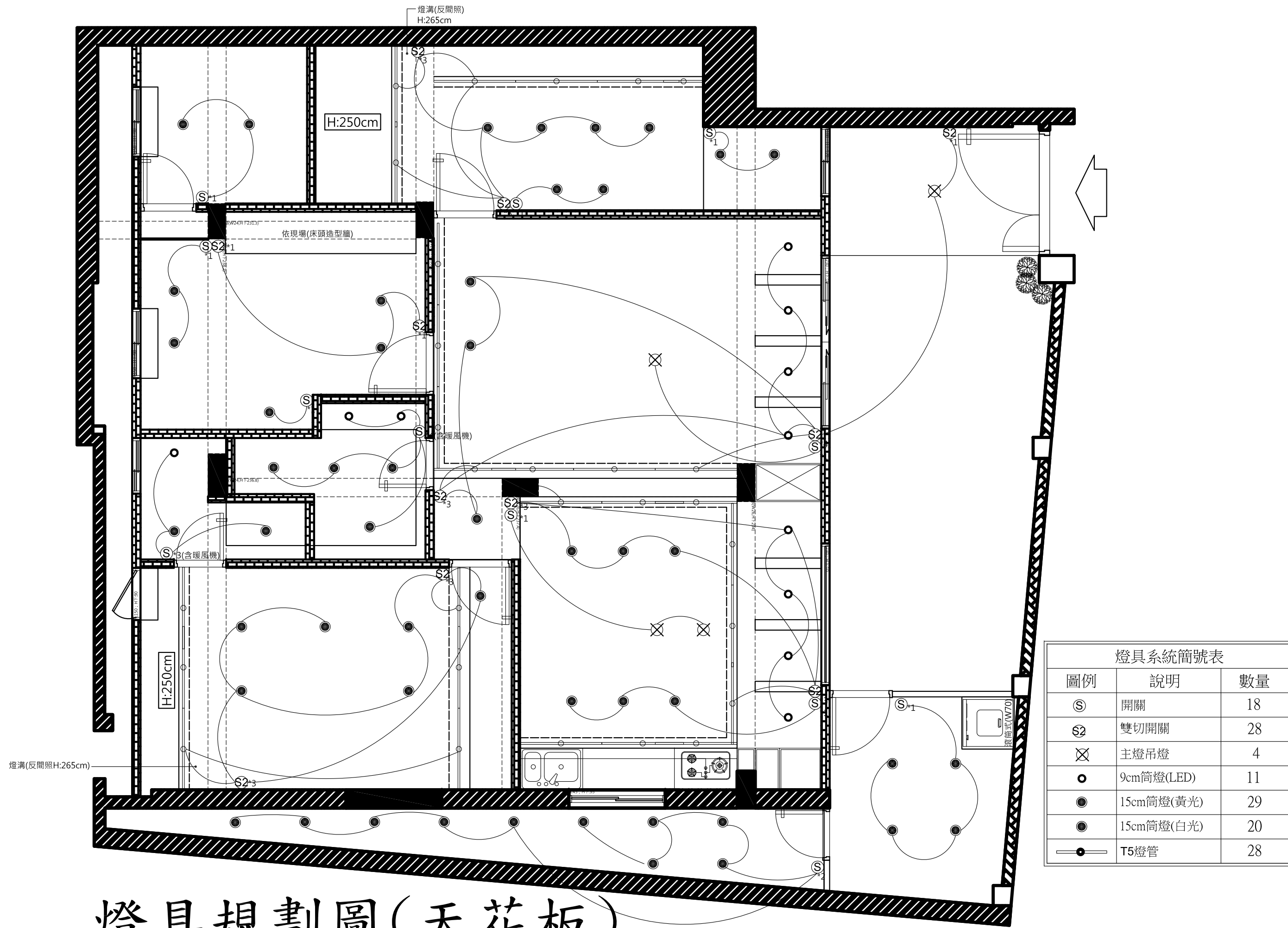

燈具規劃圖(天花板)

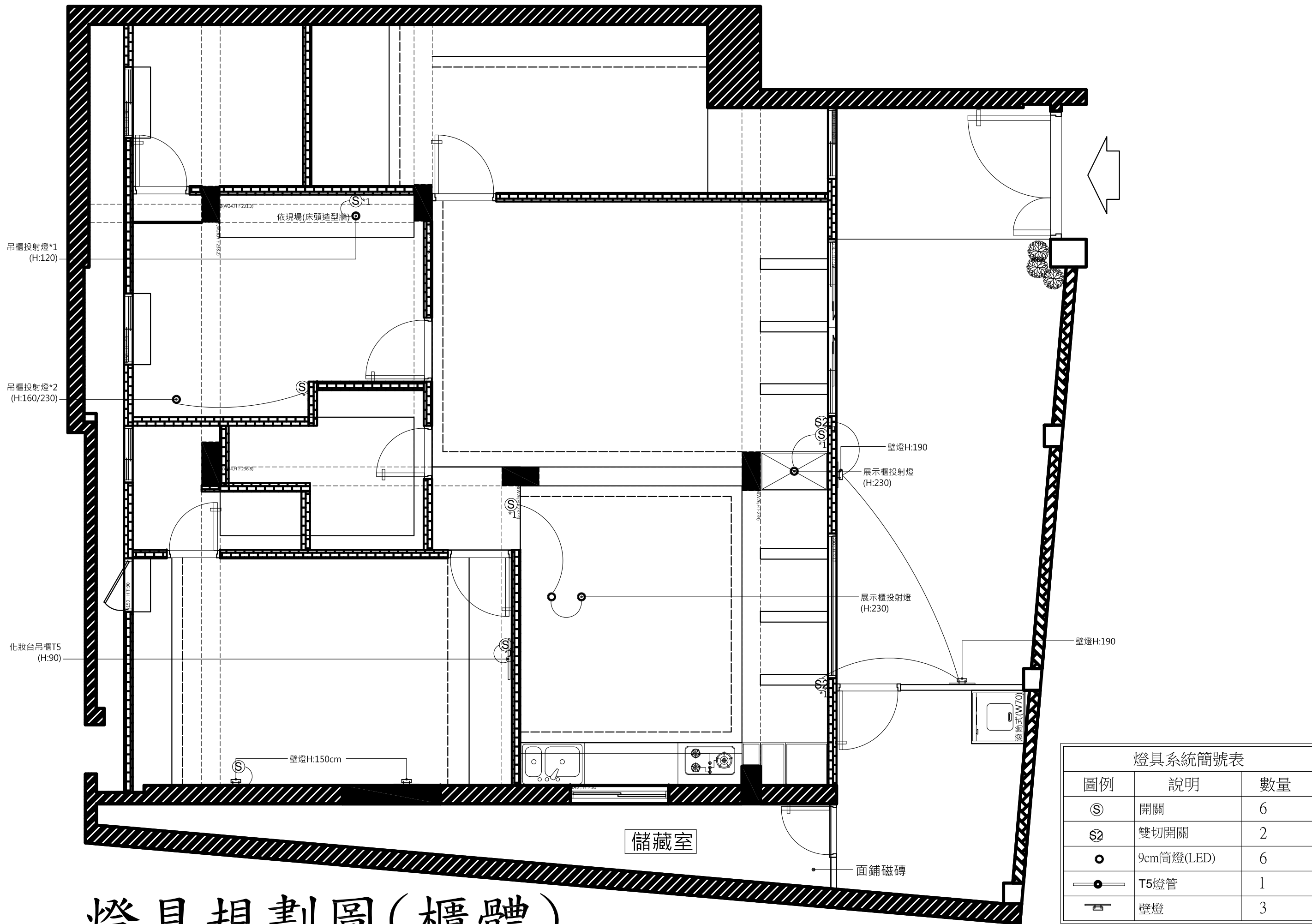

燈具規劃圖(櫃體)

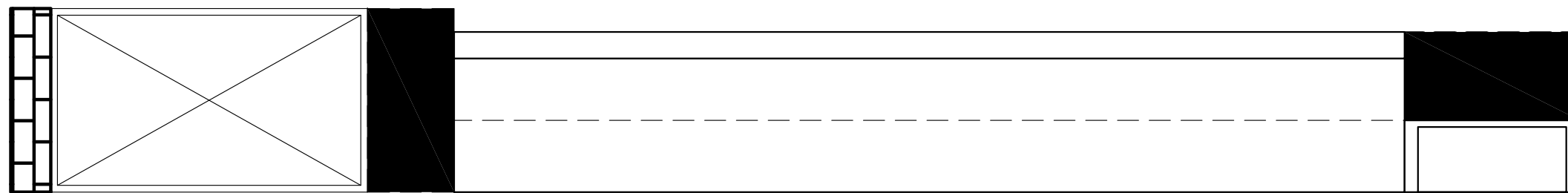

面貼木皮(白橡山紋)

上下抽屜倒斜角取手

面貼木皮(白橡山紋自然拼)

對講機放置處(底貼木皮)

木框玻璃門(面貼木皮)

嵌入不銹鋼櫃

5mm清玻璃(5分斜邊)

面貼大理石

面貼木皮(白橡山紋自然拼)

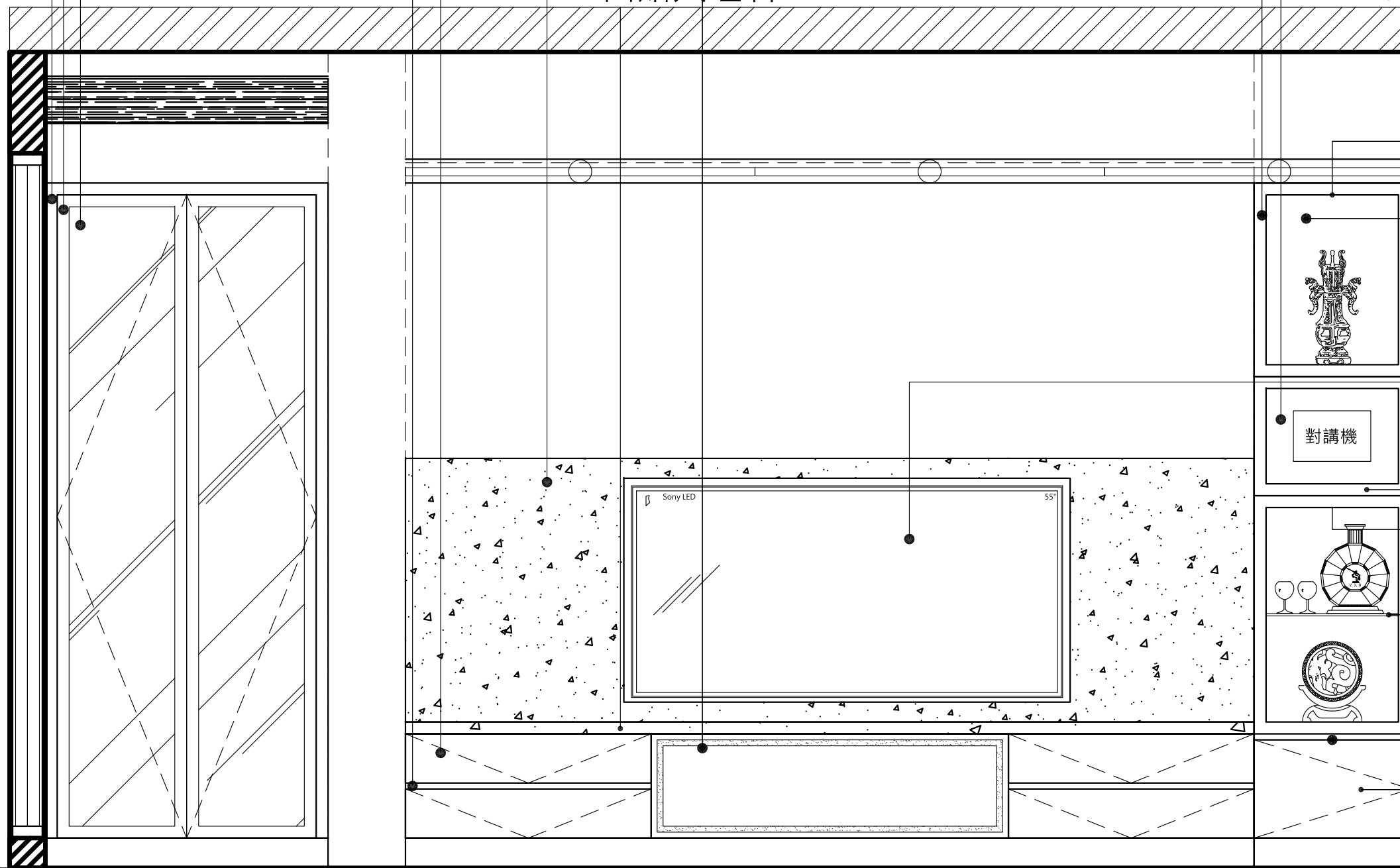

LED嵌燈

底部面貼明鏡

旋轉電視

面貼木皮(+6mm)

LED嵌燈

8mm清玻璃層板

倒斜角取手

面貼木皮
(白橡山紋自然拼)

A-1

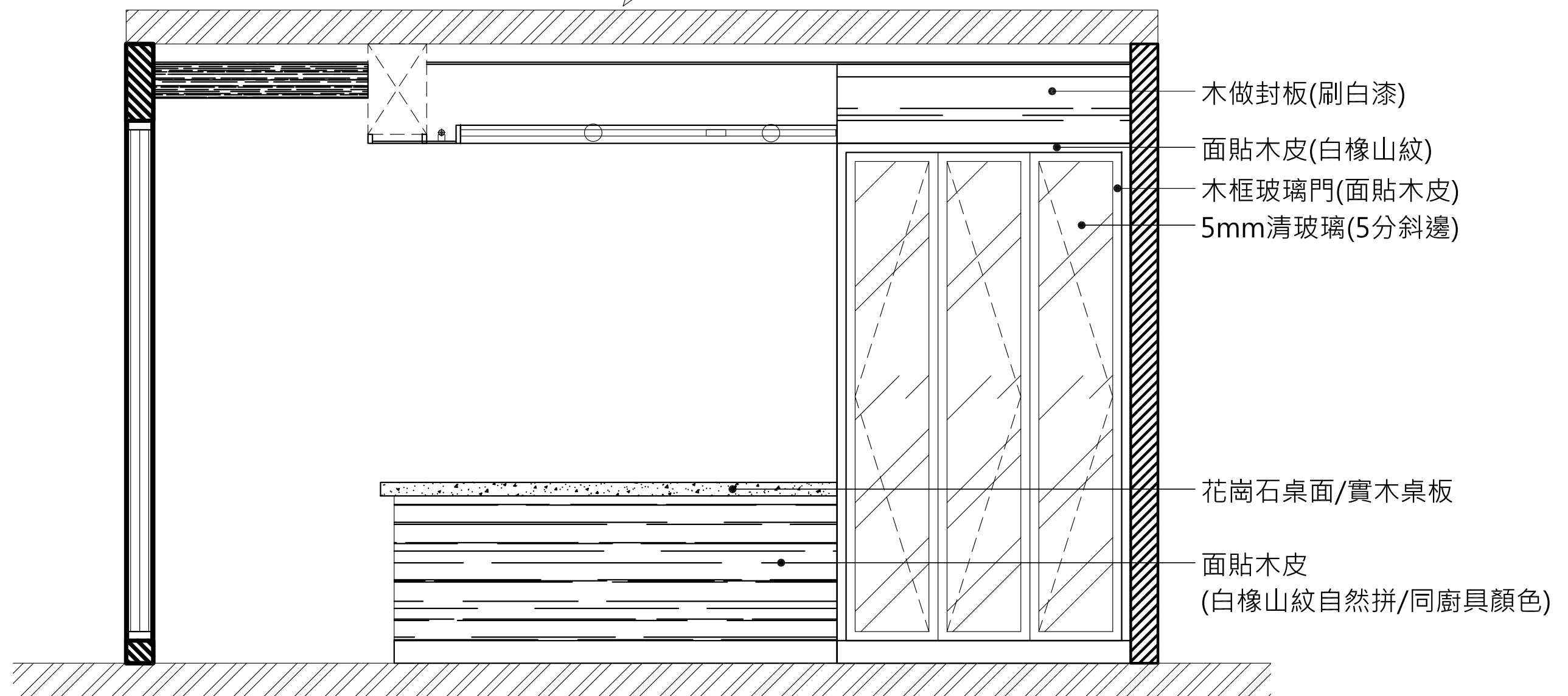
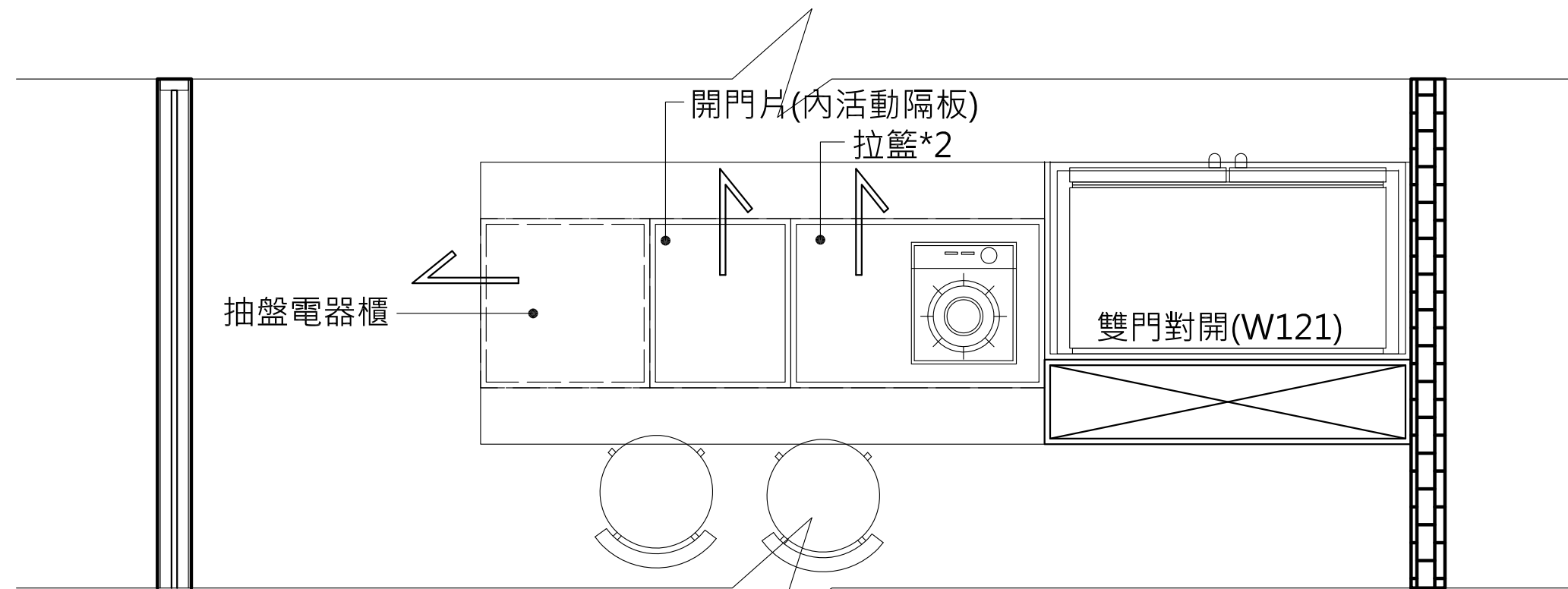

B-1

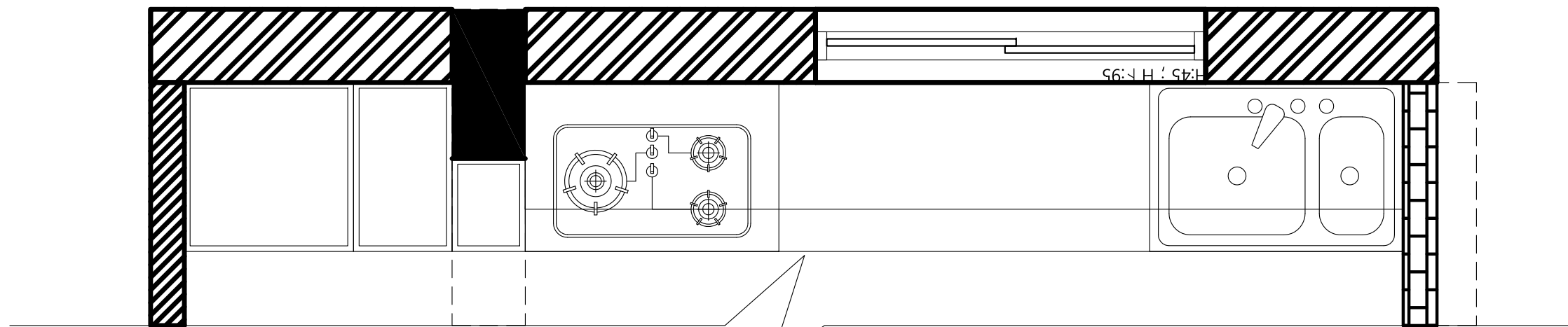

內直立式拉籃

側面置物櫃

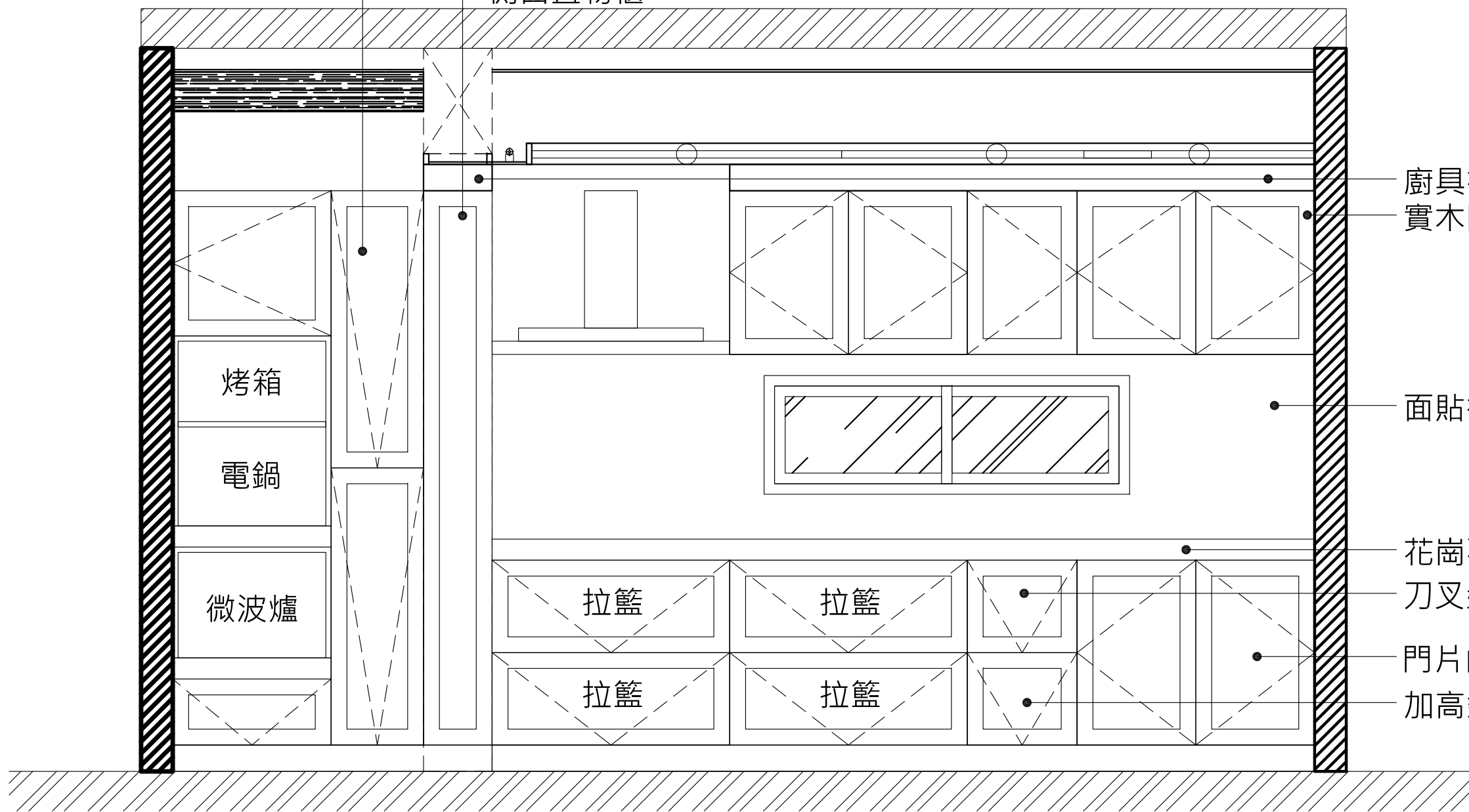

廚具補板

實木門片(橡木染色)

面貼復古磚

花崗石檯面

刀叉盤暗抽

門片內五連鉤/刀具架

加高鋁抽

烤箱

電鍋

微波爐

拉籃

拉籃

拉籃

拉籃

C-1

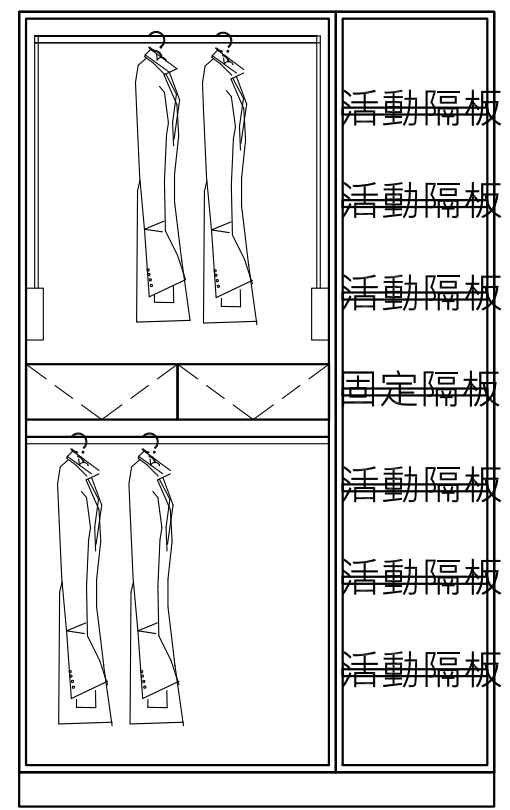
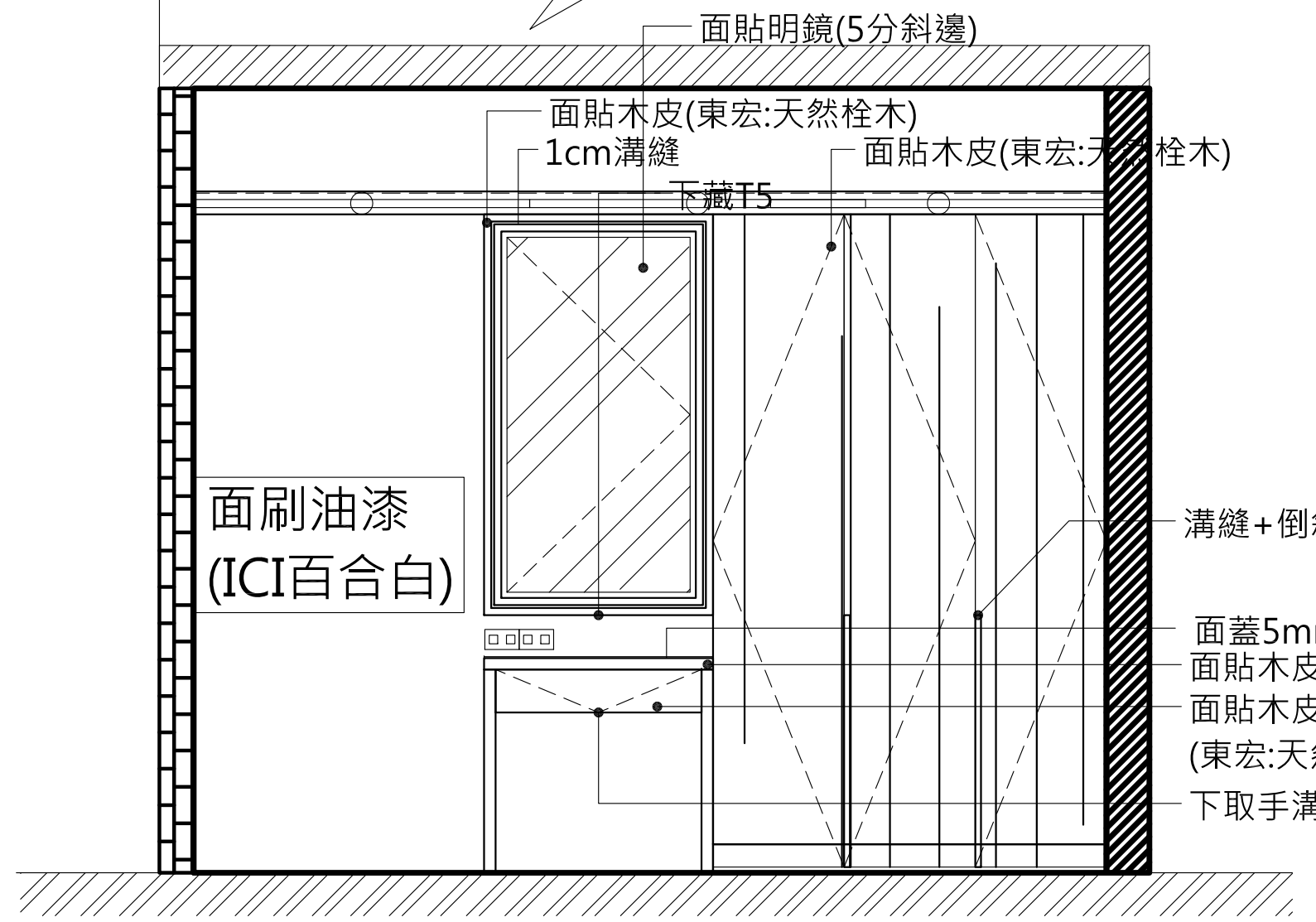
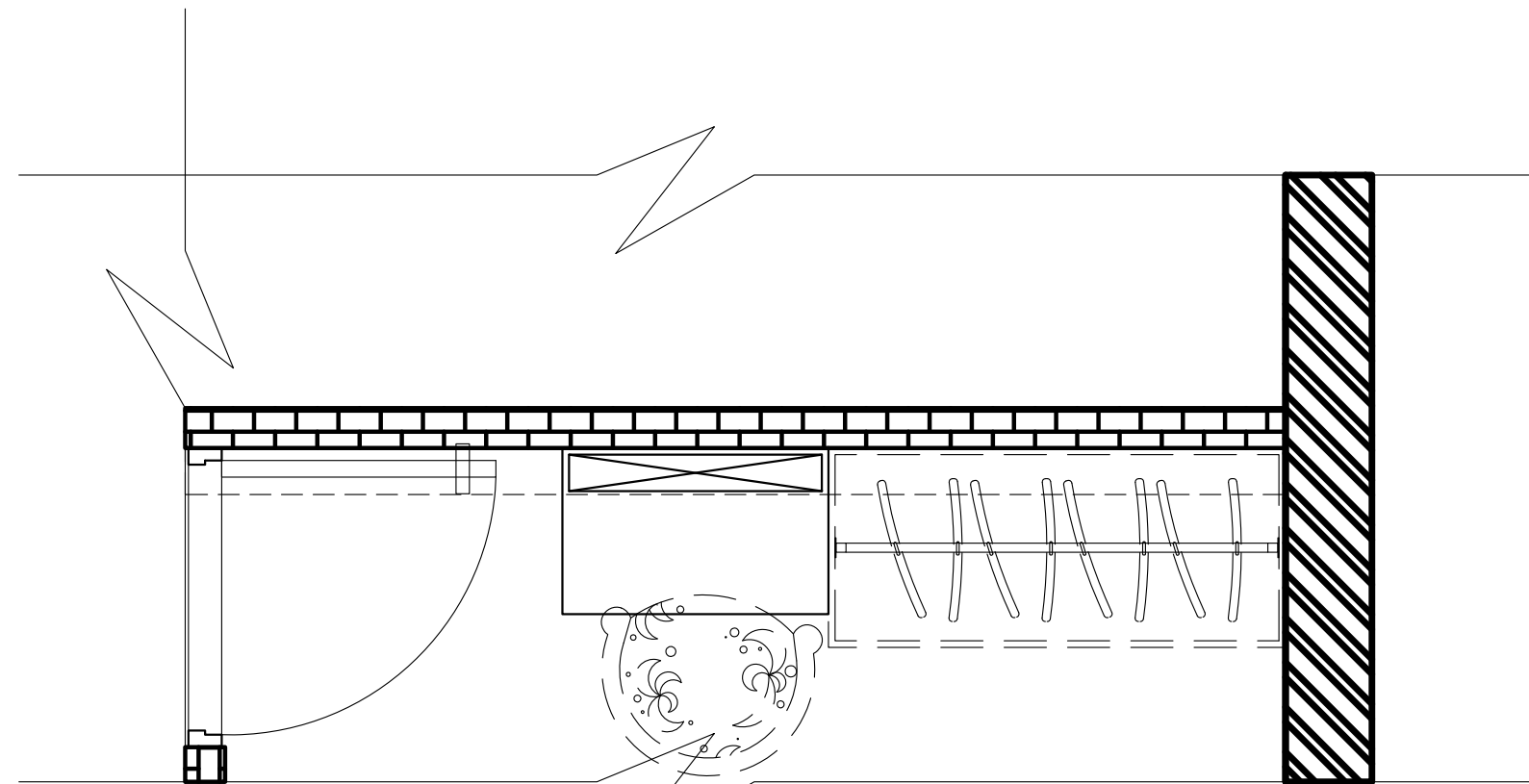

D-1

衣櫃詳細圖

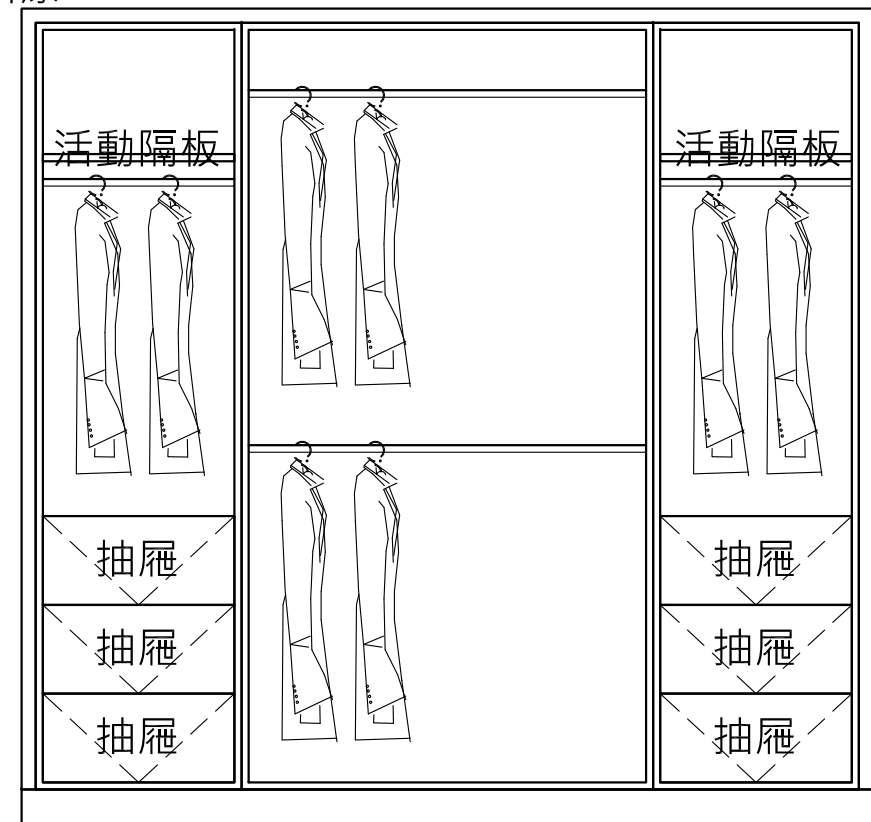
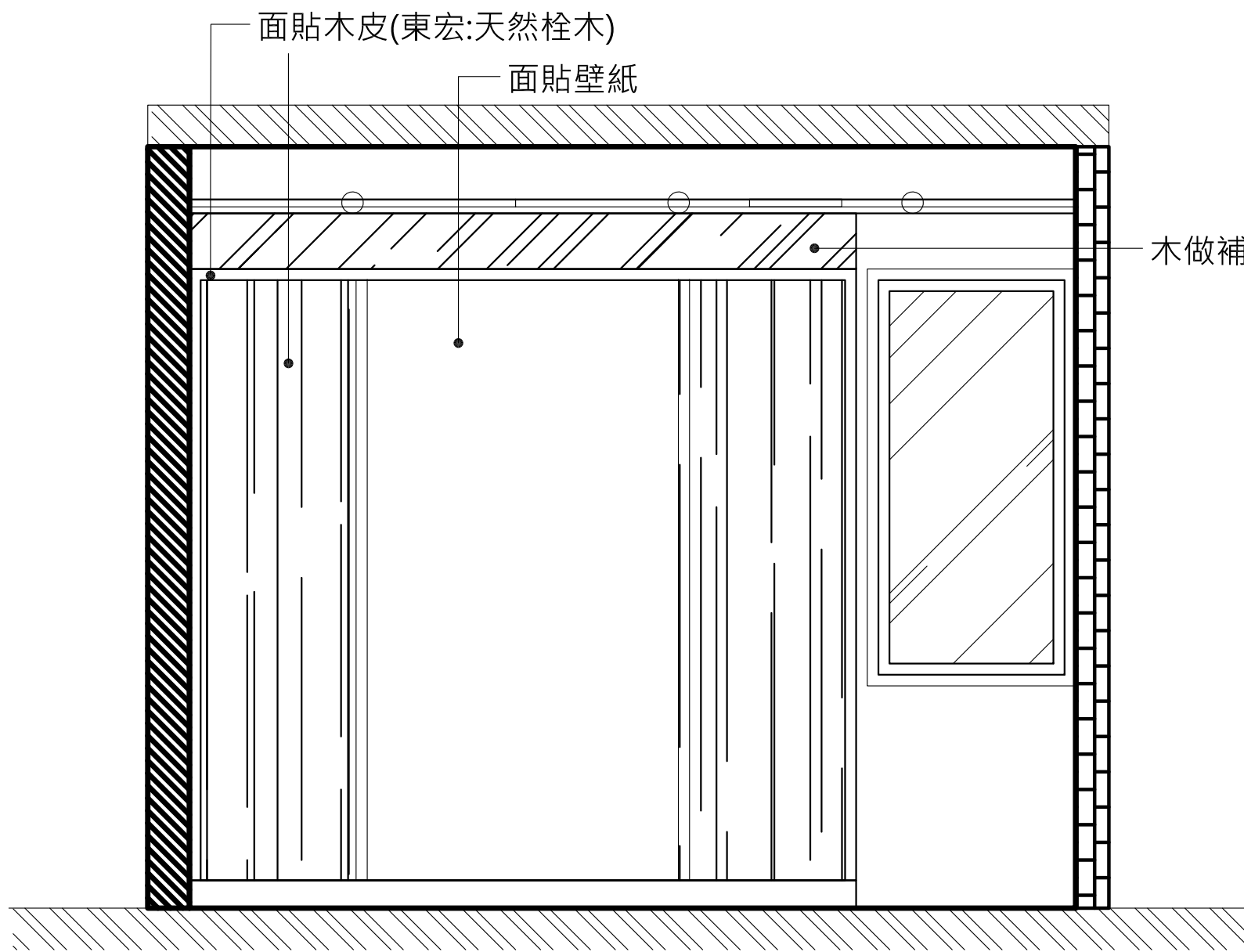
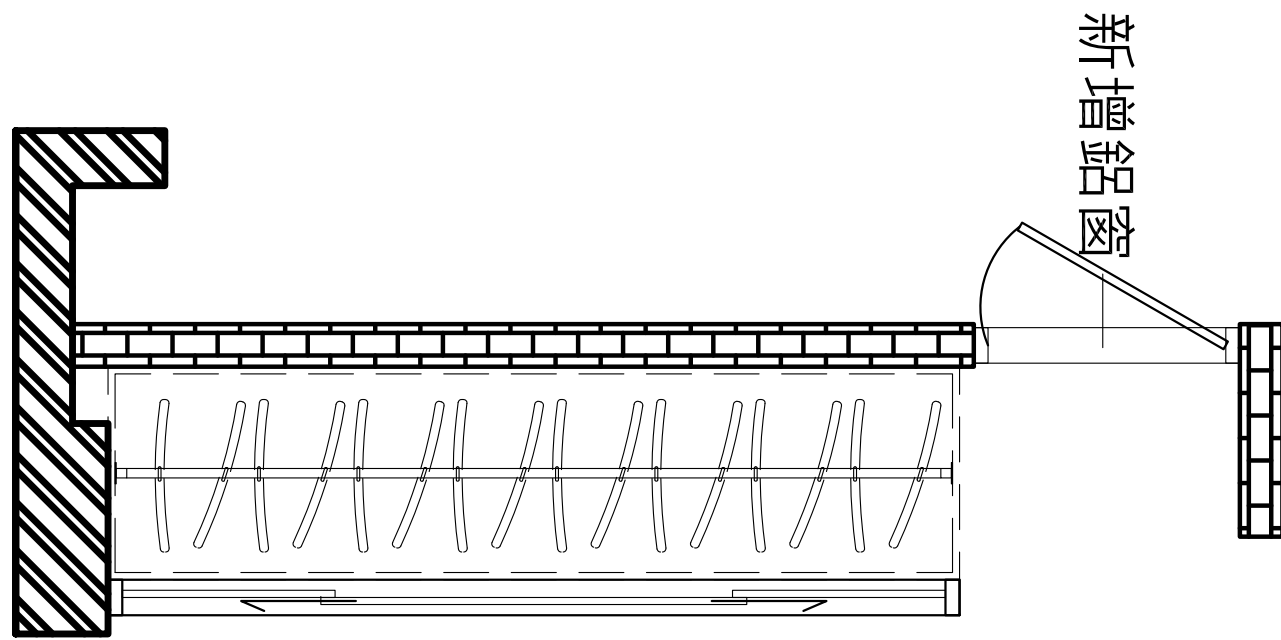

衣櫃詳細圖

D-2

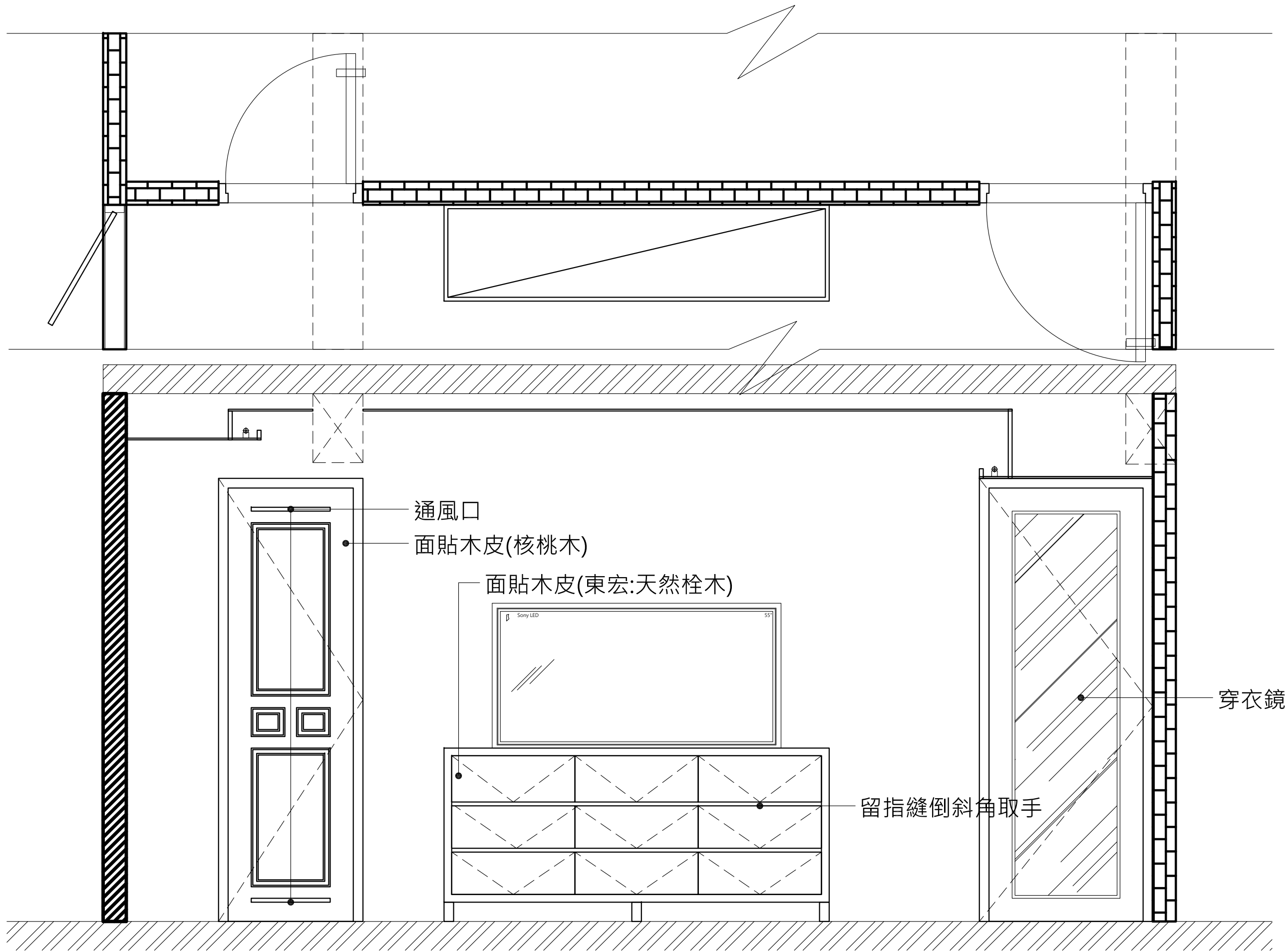

D-3

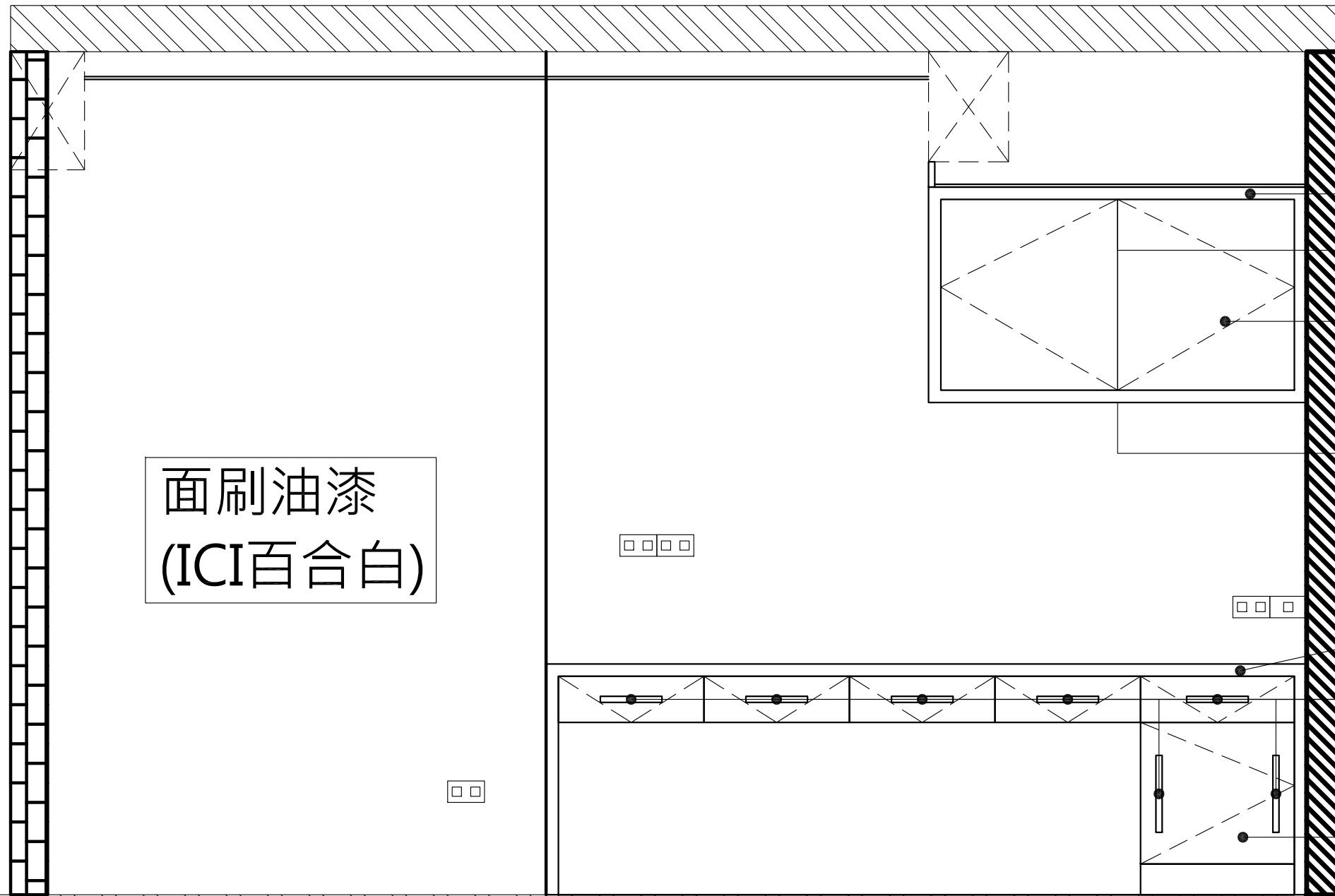
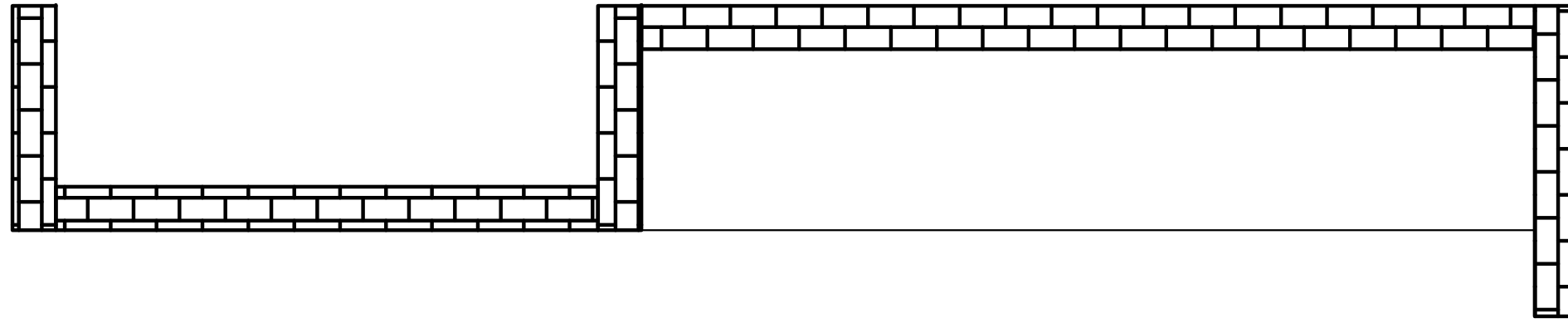

面刷油漆
(ICI百合白)

面貼木皮染色(藍灰色)

LED投射燈

鏡面玻璃門片

LED投射燈

面貼木皮染色(藍灰色)

取手溝

面貼木皮(通越:板岩EV009)

E-1

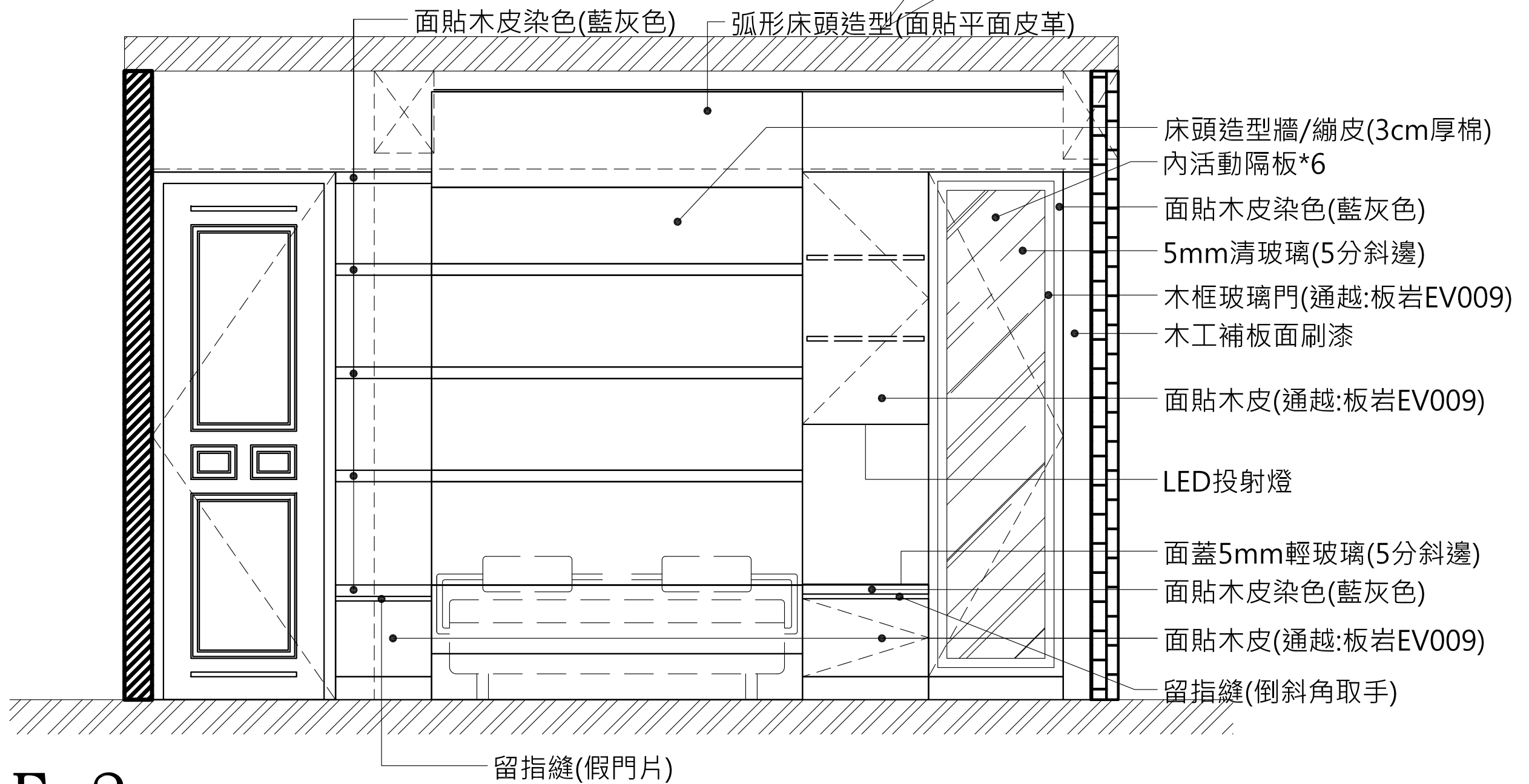
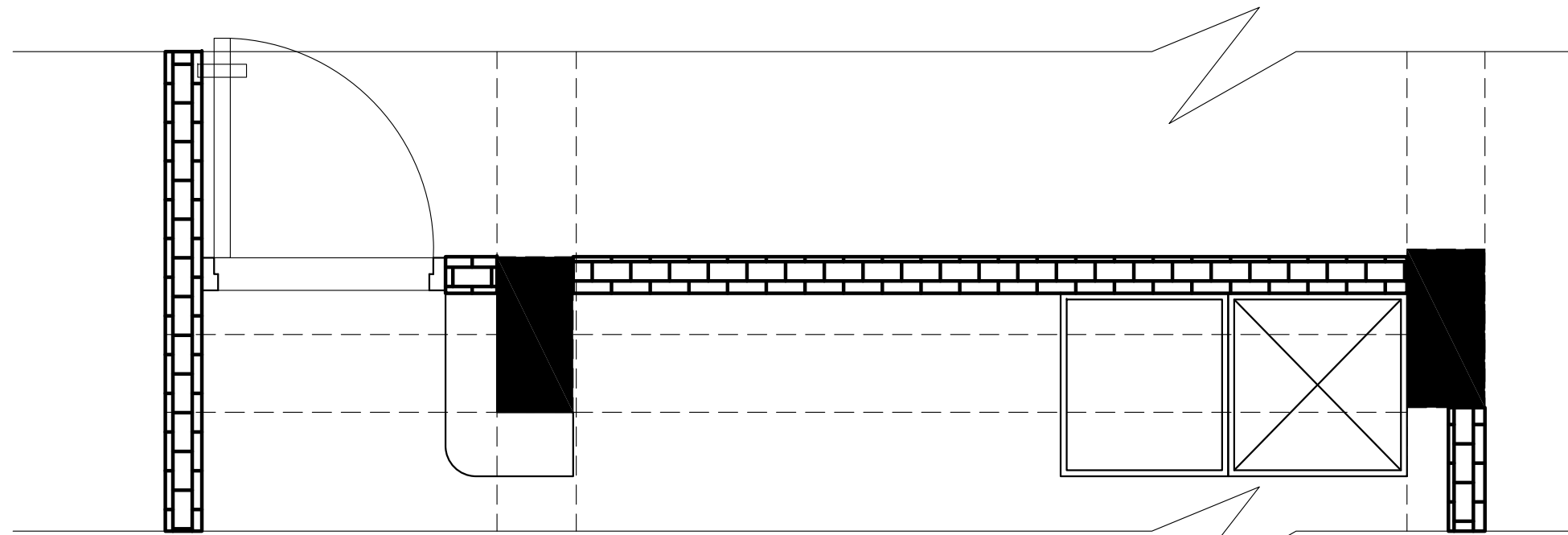

E-2

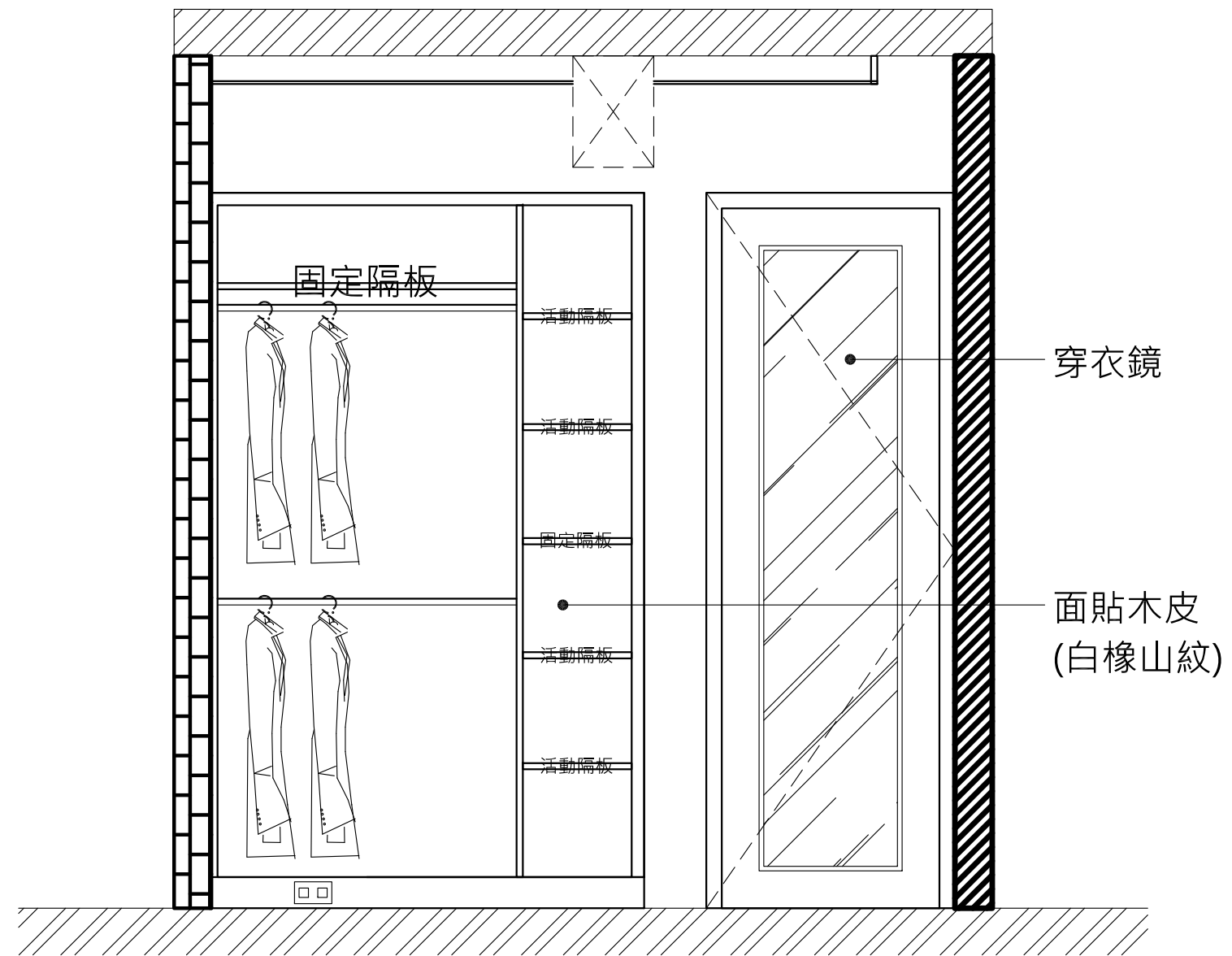
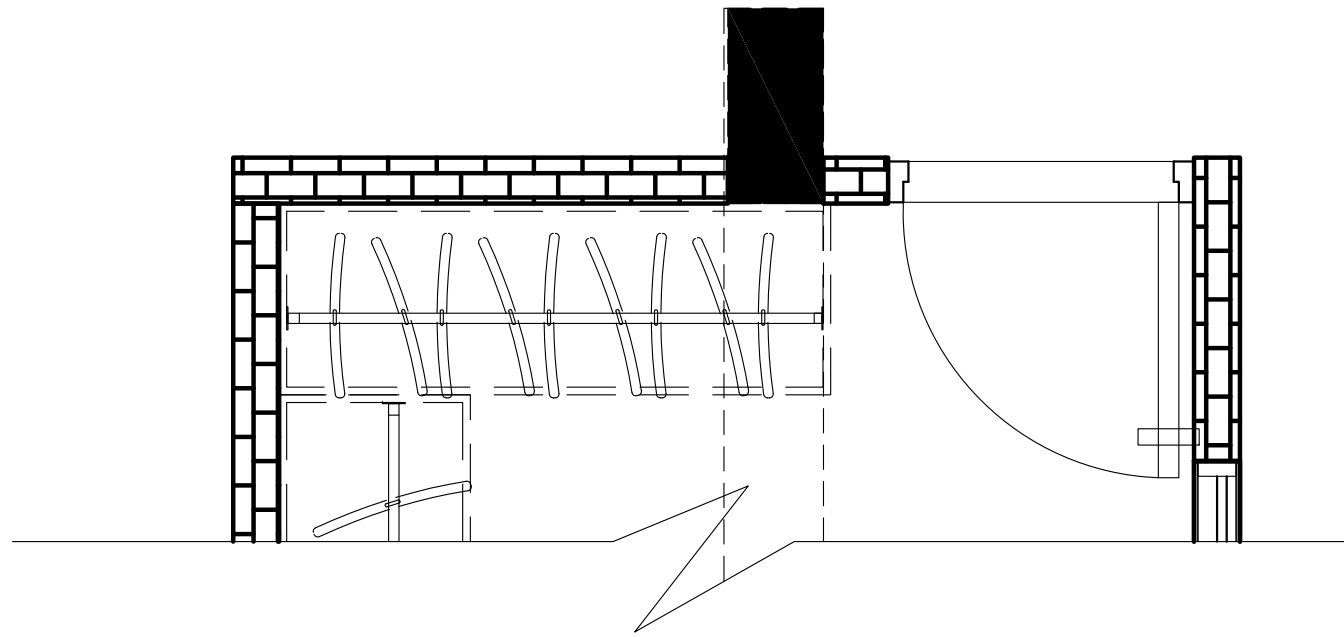

F-1

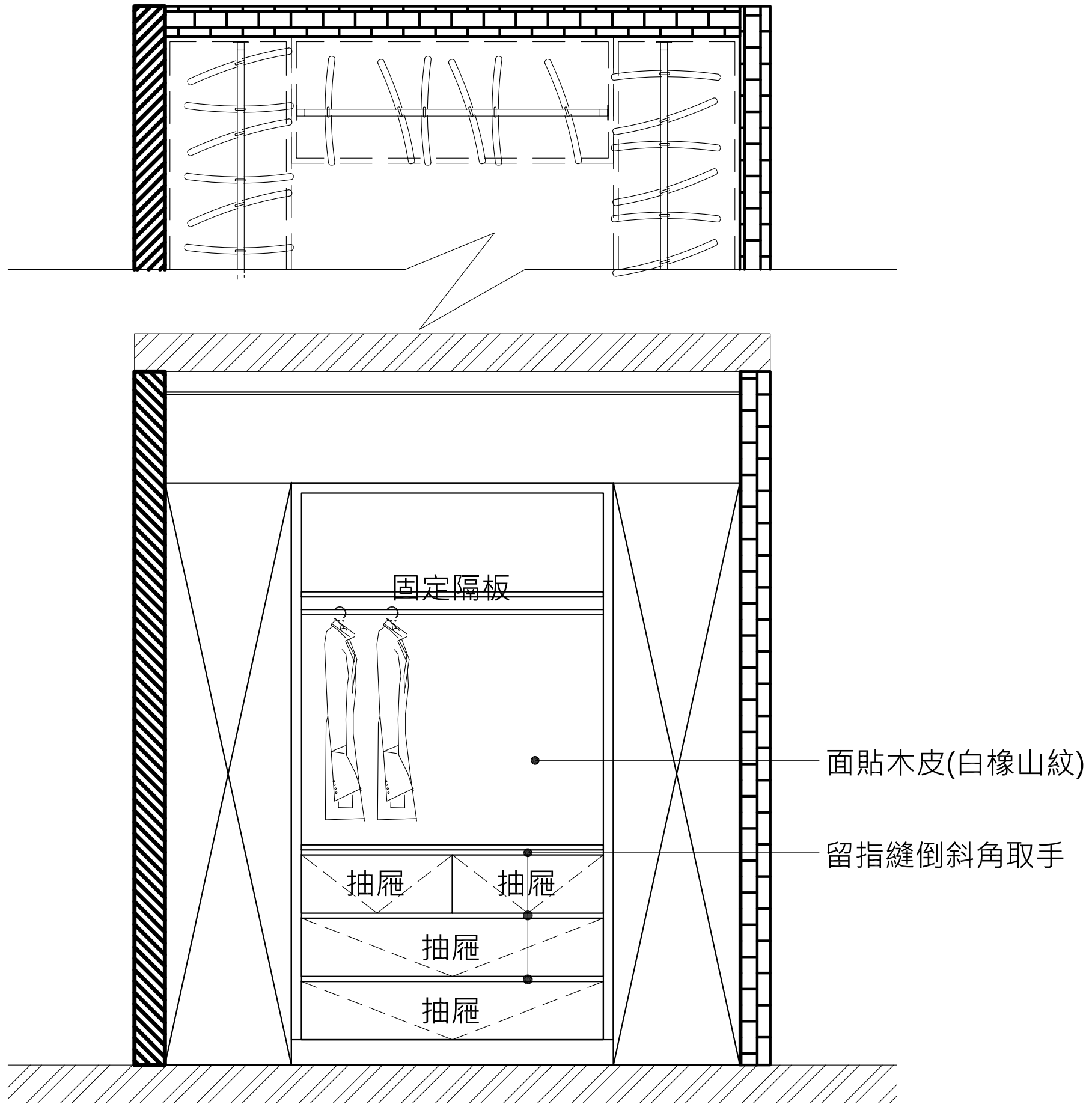

F-2

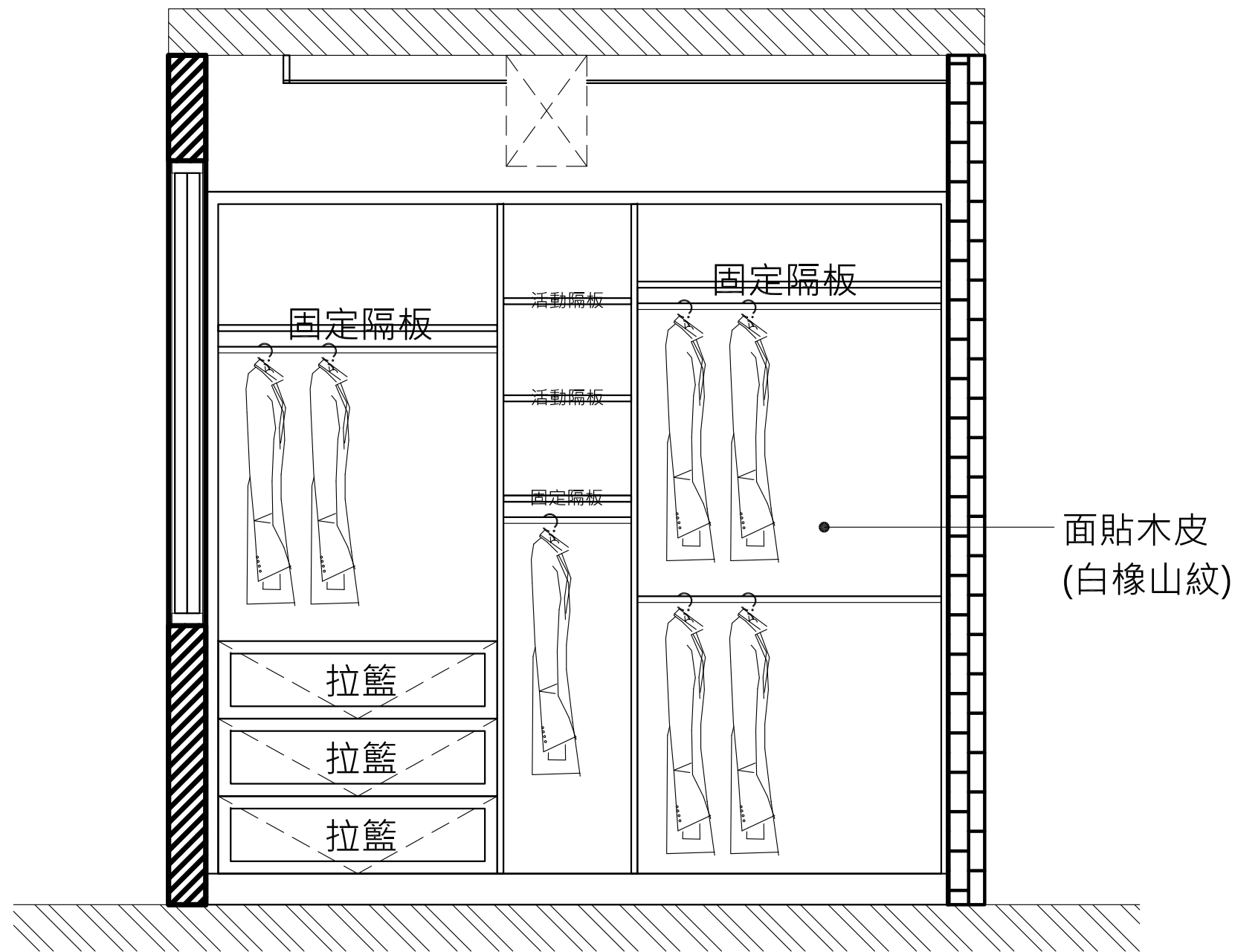
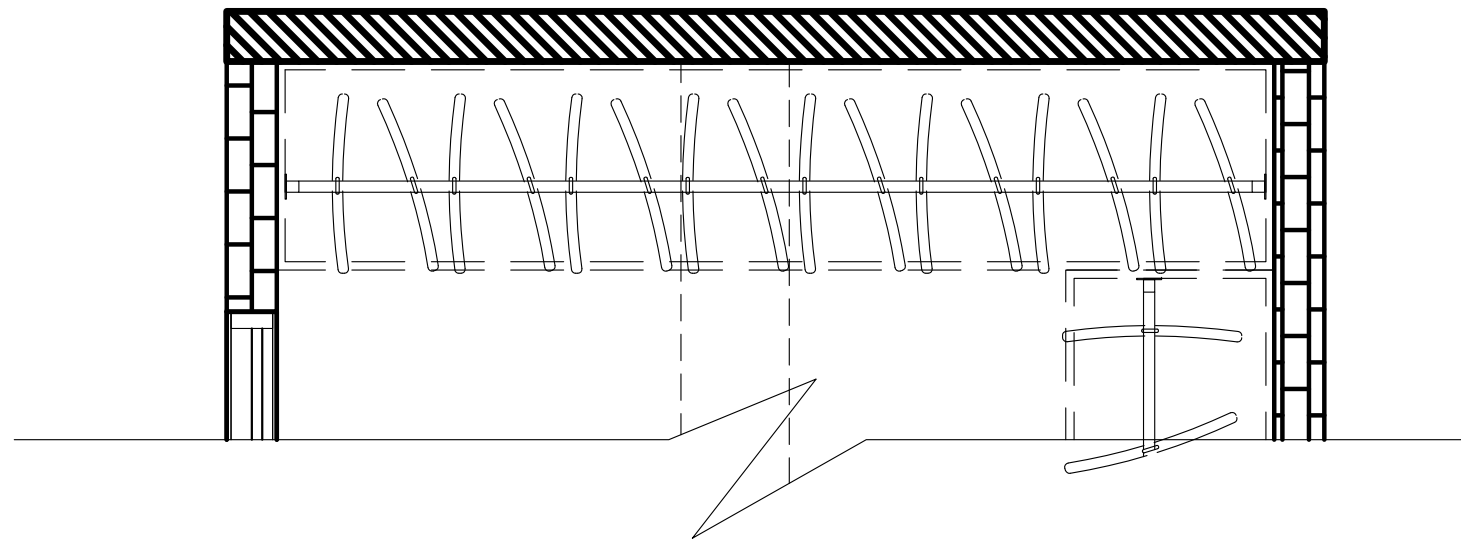

F-3

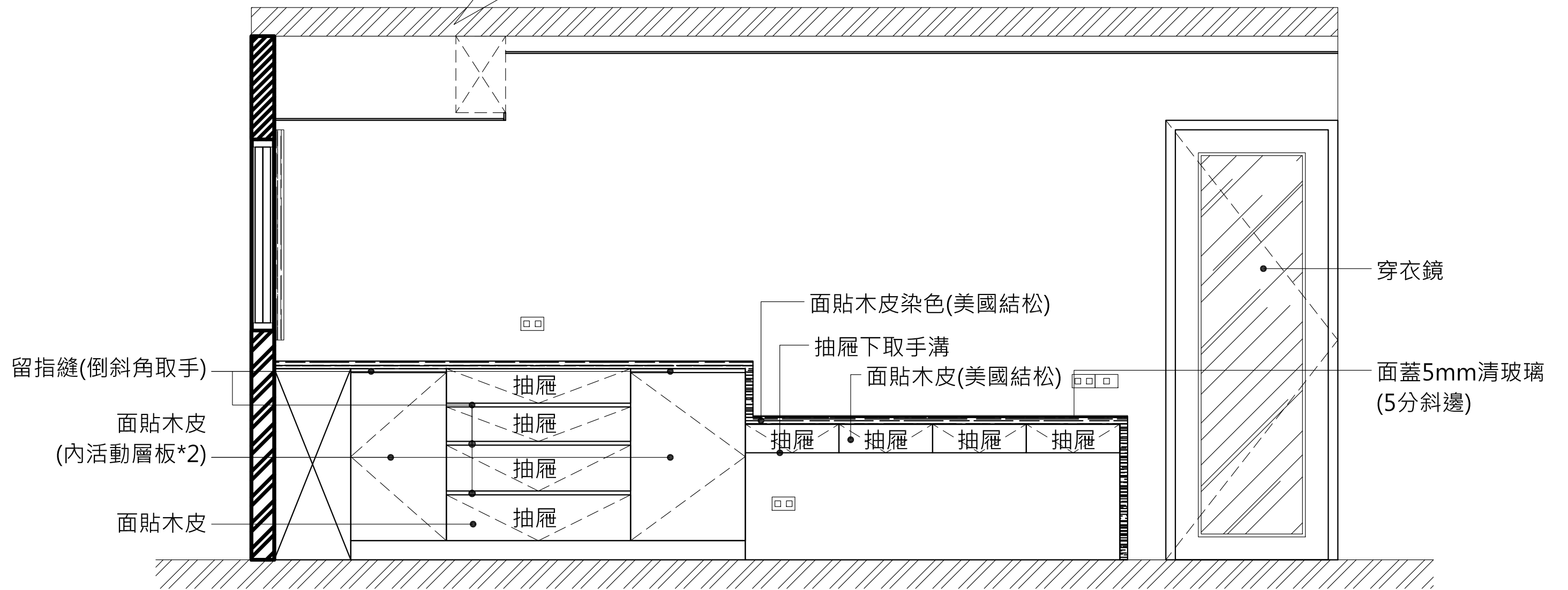
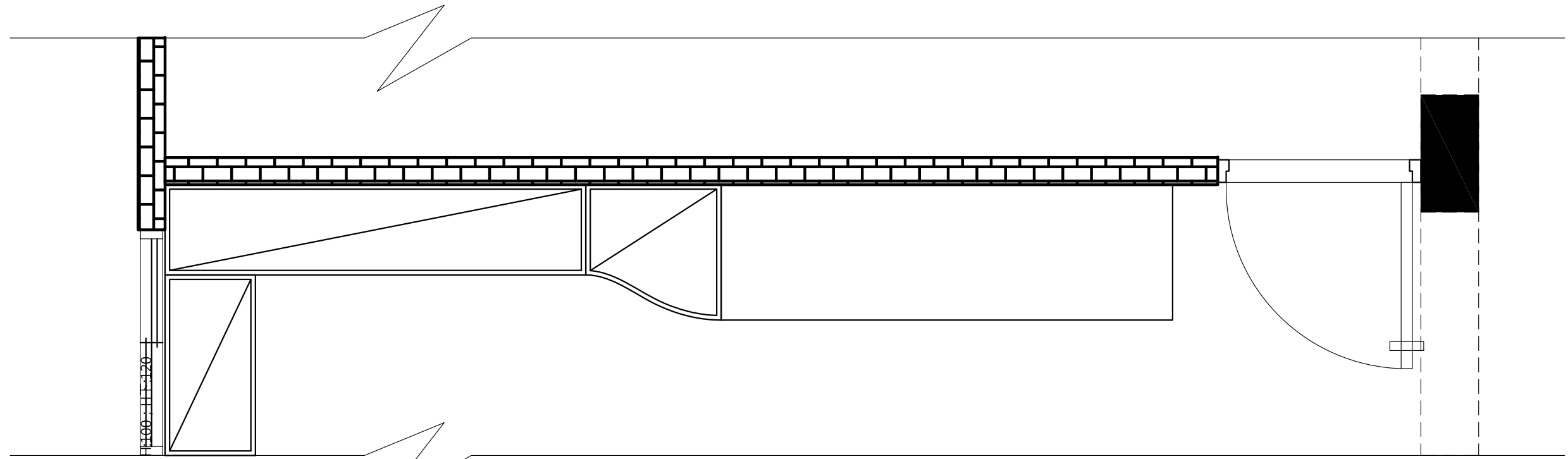

G-1

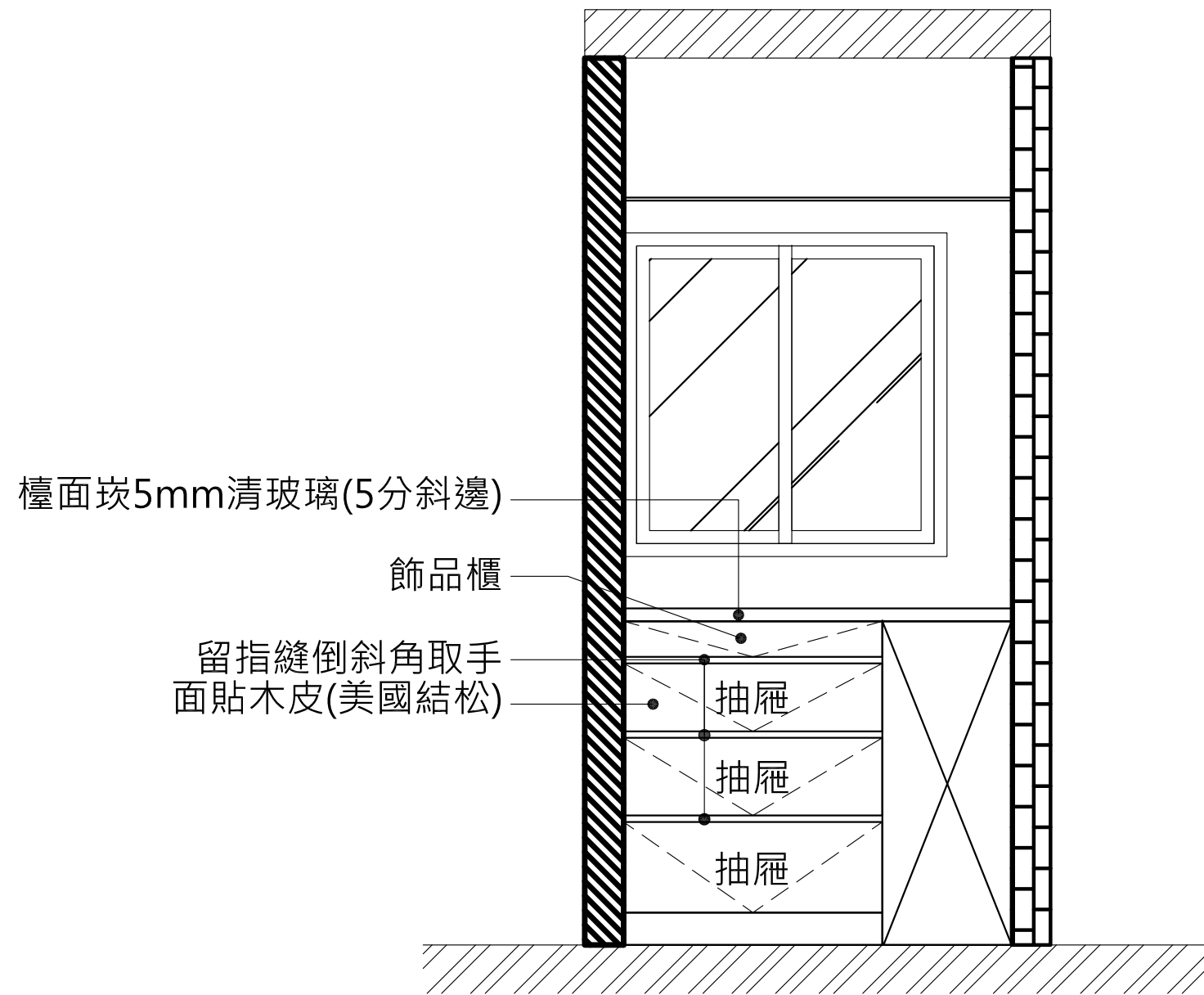
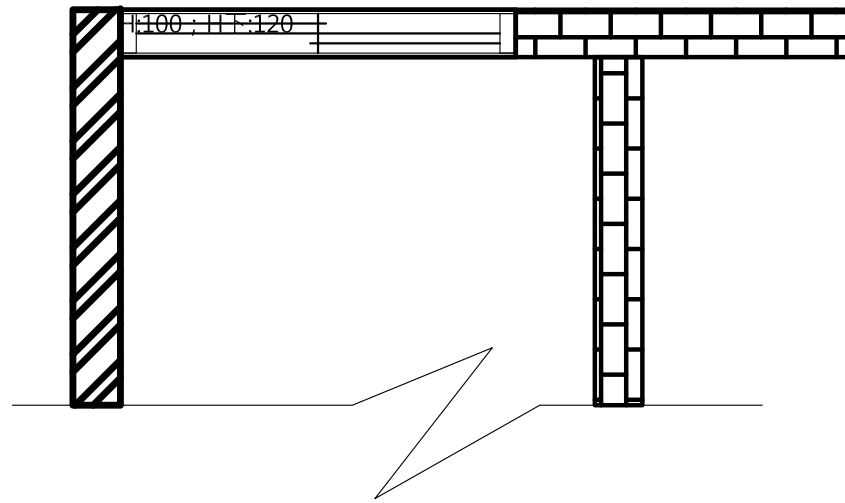

G-2

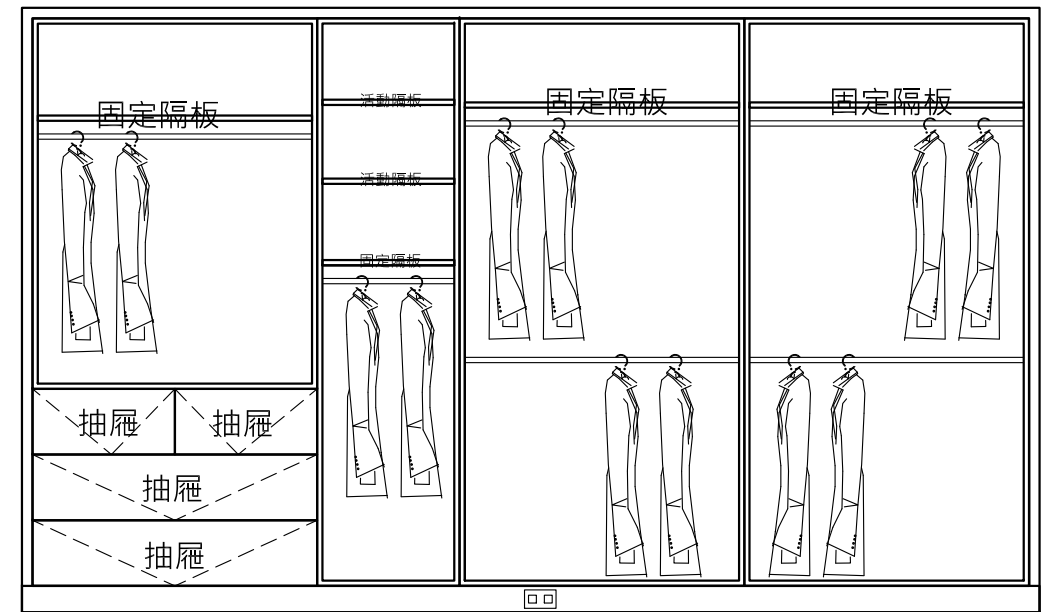
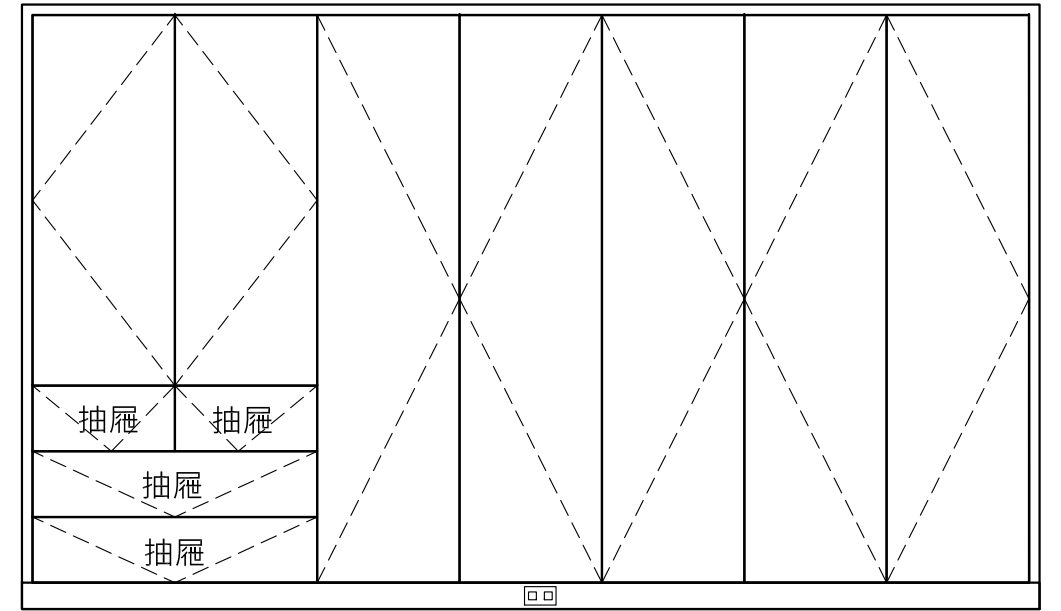
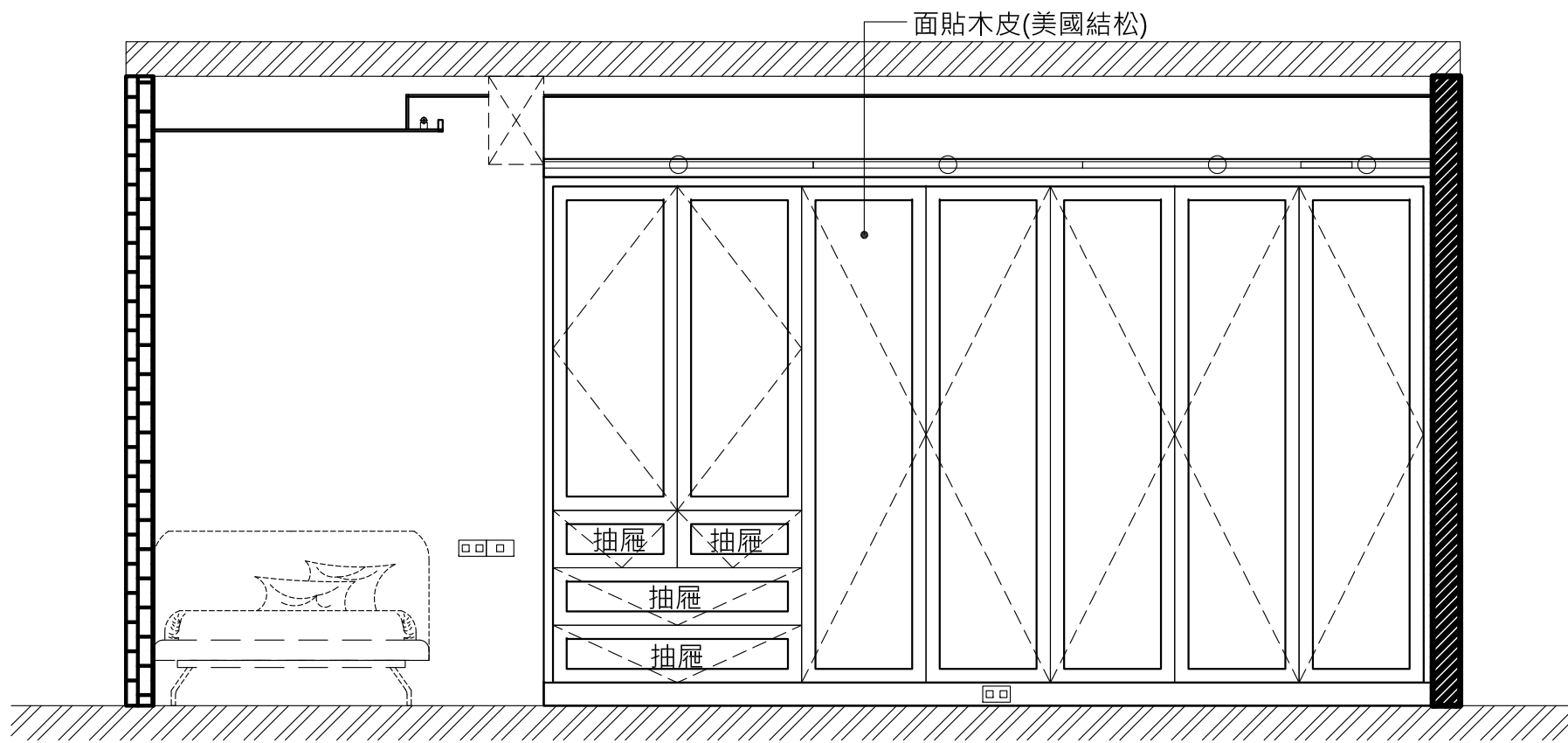
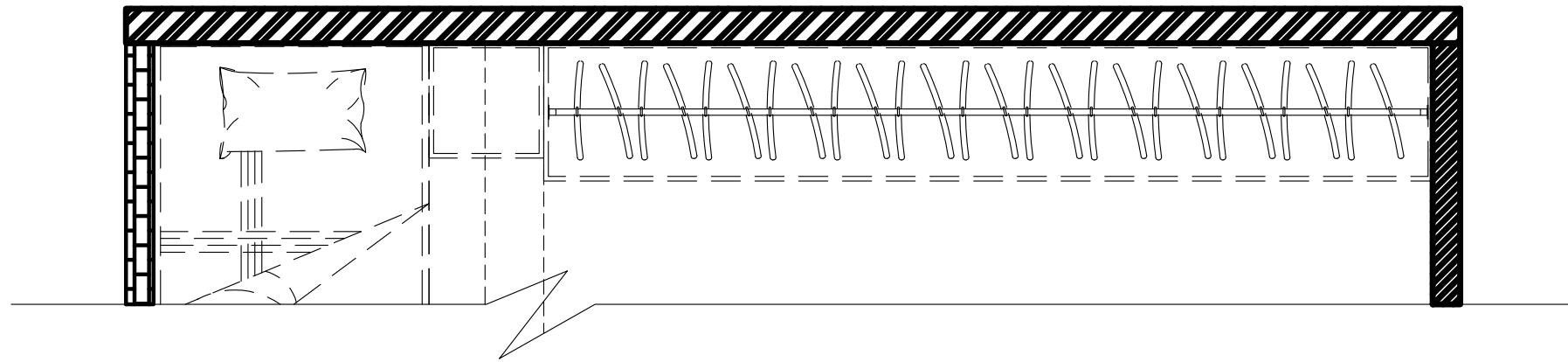

衣櫃內部圖

G-3